

| 66091 | 10/13 → Dual Shower System DN 15 | Dual Shower System DN 15 | Dual Shower System 1/2" |
|-------|-----------------------------------|------------------------------|---------------------------------|
| | 61 062 Brauseschlauch 1600 mm | shower hose 1600 mm | doucheslang 1600 mm |
| | 65 700 Handbrause DN 15 | handshower DN 15 | handdouche 1/2" |
| | 66 510 Kopfbrause | headshower | hoofddouche |
| | 73 176 Gleitschieber | Glider | glijstuk |
| | 73 179 Umsteller | diverter | omstelling |
| | 74 056 Umstellkartusche | Diverter cartridge | omstel binnenwerk |
| | 74 644 Befestigungssatz | assembling set | bevestigingsset |
| | 74 824 Brauseschlauch 800 mm | shower hose 800 mm | doucheslang 800 mm |
| | 914 551 Durchflussmengenbegrenzer | flow rate control restrictor | doorstroomhoeveelheidsbegrenzer |

KLUDI DUAL SHOWER SYSTEM

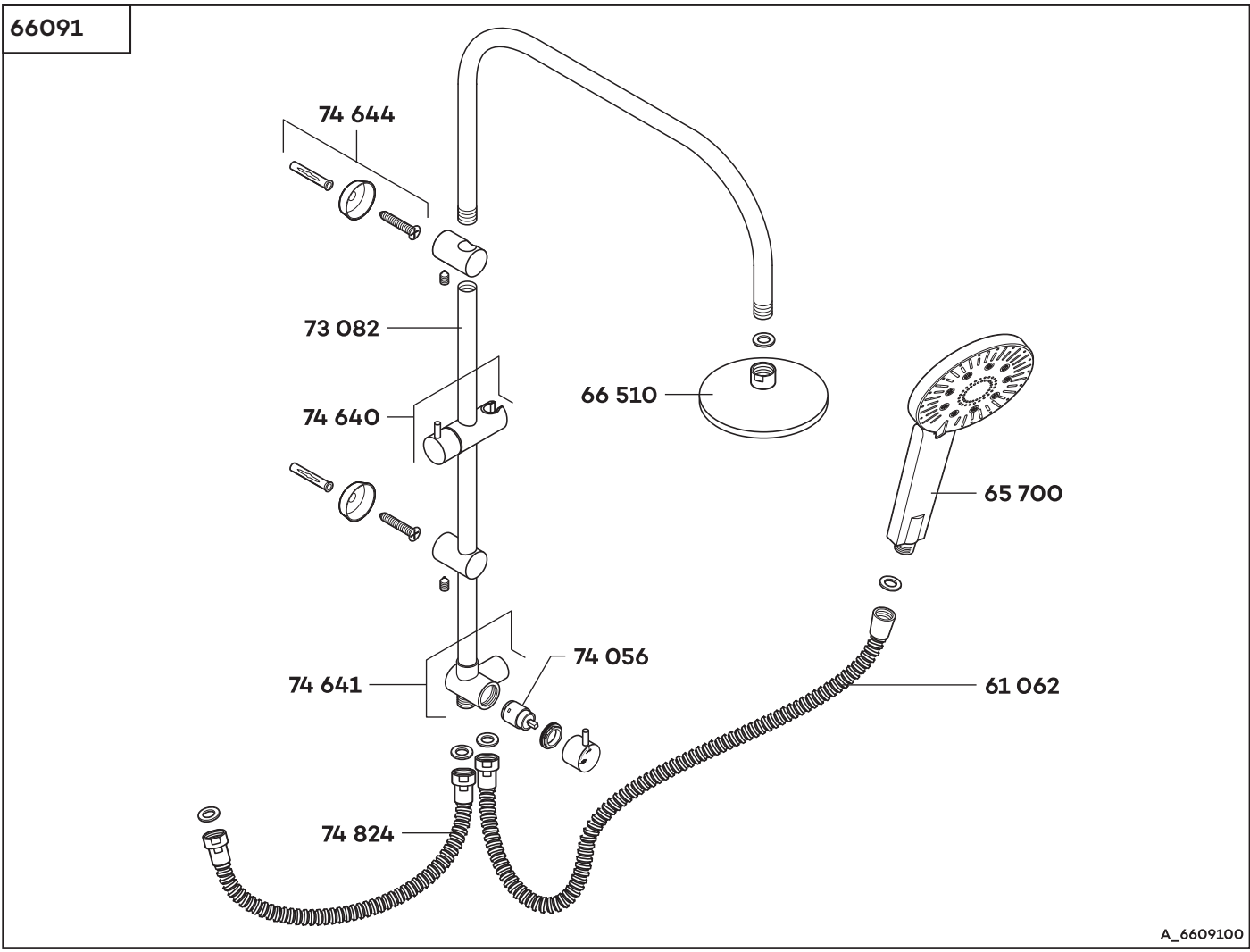

| 66091 → 09/13 | Dual Shower System | Dual Shower System | Dual Shower System |
|---------------|------------------------|---------------------|---------------------|
| 61 062 | Brauseschlauch 1600 mm | shower hose 1600 mm | doucheslang 1600 mm |
| 65 700 | Handbrause DN 15 | handshower DN 15 | handdouche DN 15 |
| 66 510 | Kopfbrause | headshower | hoofddouche |
| 73 082 | Brausestange | shower rail | glijstang |
| 74 056 | Umstellkartusche | Diverter cartridge | omstel binnenwerk |
| 74 640 | Gleitschieber | Glider | glijstuk |
| 74 641 | Umstellung | diverter | omstelling |
| 74 644 | Befestigungssatz | assembling set | bevestigingsset |
| 74 824 | Brauseschlauch 800 mm | shower hose 800 mm | doucheslang 800 mm |